

4



Appendix 1



City of  
**BRADFORD**  
METROPOLITAN DISTRICT COUNCIL

Licensing Team, Argus Chambers, Hall Ings, Bradford, BD1 1HX

**Application for a premises licence to be granted  
under the Licensing Act 2003**

**PLEASE READ THE FOLLOWING INSTRUCTIONS FIRST**

Before completing this form please read the guidance notes at the end of the form. If you are completing this form by hand please write legibly in block capitals. In all cases ensure your answers are inside the boxes and written in black ink. Use additional sheets if necessary. You may wish to keep a copy of the completed form for your records.

I/we ISRAR NABI (CHA CHA CHAI) (insert name(s) of applicant)  
apply for a premises licence under section 17 of the Licensing Act 2003 for the premises described in Part 1 below (the premises) and I/we are making this application to you as the relevant licensing authority in accordance with section 12 of the Licensing Act 2003

**Part 1 – Premises Details**

Postal address of premises or, if none, Ordnance Survey map reference or description <u>UNIT 6 CHA CHA CHAI INGLEBY ROAD</u>		<b>MAIL PRINT</b> 10 FEB 2021 <b>SCAN STORE</b>
Post town <u>BRADFORD</u>	Post code <u>BD8 9AN</u>	

Telephone number of premises (if any)

Non domestic rateable value of premises

**Part 2 – Applicant Details**

Please state whether you are applying for a premises licence as:

- Please tick as appropriate
- a) an individual or individuals\*  please complete section (A)
  - b) a person other than an individual\*
    - i. as a limited company/limited liability partnership  please complete section (B)
    - ii. as a partnership (other than limited liability)  please complete section (B)
    - iii. as an unincorporated association or  please complete section (B)
    - iv. other (for example a statutory corporation)  please complete section (B)
  - c) a recognised club  please complete section (B)

MORRISONS PETROL STATION

Mc DONALDS 24hrs

WALLIS STREET

SUBWAYS

DOMINOS PIZZA

CAR PARK

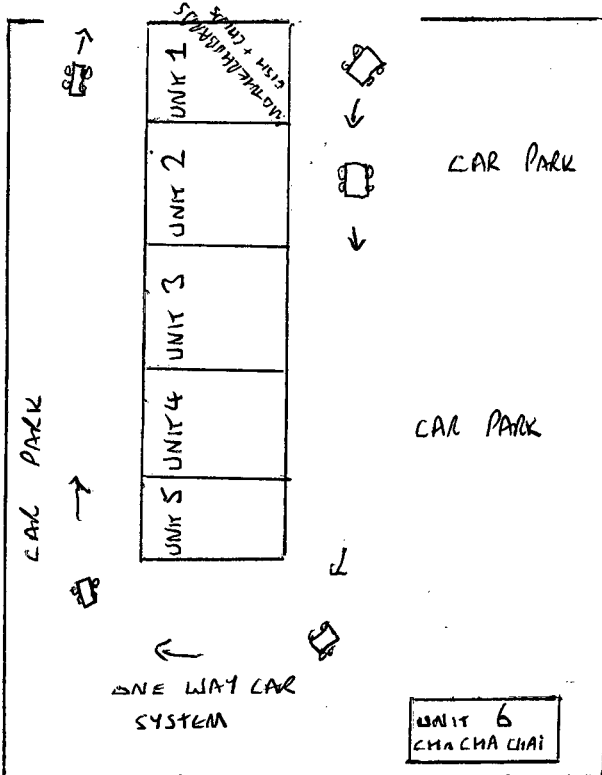

LIDL SUPERMARKET

LIDL CARPARK

INGLEBY ROAD

CAR PARK

AMSONS

- d) a charity  please complete section (B)
- e) the proprietor of an educational establishment  please complete section (B)
- f) a health service body  please complete section (B)
- g) a person who is registered under Part 2 of the Care Standards Act 2000 (c14) in respect of an independent hospital in Wales  please complete section (B)
- ga) a person who is registered under Chapter 2 of Part 1 of the Health and Social Care Act 2008 (within the meaning of that part) in an independent hospital in England  please complete section (B)
- h) the chief officer of police of a police force in England and Wales  please complete section (B)

\*If you are applying as a person described in (a) or (b) please confirm (by ticking yes to one box below:

- I am carrying on or proposing to carry on a business which involves the use of the premises for licensable activities; or
- I am making the application pursuant to a
  - statutory function or
  - a function discharged by virtue of Her Majesty's prerogative

**(A) INDIVIDUAL APPLICANTS** (fill in as applicable)

Mr  Mrs  Miss  Ms  Other title (for example, Rev) \_\_\_\_\_

Surname  First names

Please tick yes

Date of Birth  I am 18 years old or over

Nationality

Current postal address if different from premises address

Post Town  Postcode

Daytime contact telephone number

Email address (optional)

Where applicable (if demonstrating a right to work via the Home Office online right to work checking service), the 9 digit 'share code' provided to the applicant by that service (please see note 2 for information)

**SECOND INDIVIDUAL APPLICANT** (if applicable)

Mr  Mrs  Miss  Ms  Other title (for example, Rev) \_\_\_\_\_

Surname

First names

Please tick yes

Date of Birth

I am 18 years old or over

Nationality

Current postal address if different from premises address

Post Town

Postcode

Daytime contact telephone number

Email address (optional)

Where applicable (if demonstrating a right to work via the Home Office online right to work checking service), the 9 digit 'share code' provided to the applicant by that service (please see note 2 for information)

**(B) OTHER APPLICANTS**

Please provide name and registered address of applicant in full. Where appropriate please give any registered number. In case of a partnership or other joint venture (other than a body corporate), please give the name and address of each party concerned.

Name	ISRAR NABI	
Address	CHA CHA CHAI UNIT 6 INGLEBY ROAD BRADFORD BD8 9AN	
Registered number (where applicable)	CHA CHA CHAI INGLEBY LTD COMPANY REGISTER NO 11692216	

Description of applicant (for example, partnership, company, unincorporated association etc.)	
LIMITED COMPANY	
Telephone number (if any)	[REDACTED]
E-mail address (optional)	

**Part 3 Operating Schedule**

AS SOON AS POSSIBLE

When do you want the premises licence to start?

Day		Month		Year	
21	3	07	2	0	20

If you wish the licence to be valid only for a limited period, when do you want it to end?

Day		Month		Year	

Please give a general description of the premises (please read guidance note 1)

SINGLE STOREY 40 FT DETACHED BUILDING LOCATED WITHIN A FOOD COURT OF FIVE OTHER FOOD OUTLETS. LARGE CARPARKING FOR OVER 100 VEHICLES. CAFE IS THE MAIN USE SERVING HOT DRINKS AND LIGHT SNACKS AND REFRESHMENTS.

If 5,000 or more people are expected to attend the premises at any one time, please state the number expected to attend

N/A
-----

What licensable activities do you intend to carry on from the premises?

(Please see sections 1 and 14 of the Licensing Act 2003 and Schedules 1 and 2 to the Licensing Act 2003)

Please tick  yes

**Provision of regulated entertainment**

- a) plays (if ticking yes, fill in box A)
- b) films (if ticking yes, fill in box B)
- c) indoor sporting events (if ticking yes, fill in box C)
- d) boxing or wrestling entertainment (if ticking yes, fill in box D)
- e) live music (if ticking yes, fill in box E)
- f) recorded music (if ticking yes, fill in box F)
- g) performance of dance (if ticking yes, fill in box G)
- h) anything of a similar description to that falling within (e), (f) or (g) (if ticking yes, fill in box H)

**Provision of late night refreshment** (if ticking yes, fill in box I)

**Sale by retail of alcohol** (if ticking yes, fill in box J)

**In all cases complete boxes K, L and M**

# A

<b>Plays</b> Standard days and timings (please read guidance note 7)			<b>Will the performance of a play take place indoors or outdoors or both – please tick (please read guidance note 3)</b>	Indoors	<input type="checkbox"/>
				Outdoors	<input type="checkbox"/>
				Both	<input type="checkbox"/>
<b>Day</b>	<b>Start</b>	<b>Finish</b>	<b>Please give further details here (please read guidance note 4)</b>		
Mon					
Tue			<b>State any seasonal variations for performing play (please read guidance note 5)</b>		
Wed					
Thur					
Fri			<b>Non standard timings. Where you intend to use the premises for the performance of plays at different times to those listed in the column on the left, please list (please read guidance note 6)</b>		
Sat					
Sun					

# B

<b>Films</b> Standard days and timings (please read guidance note 7)			<b>Will the exhibition of a films take place indoors or outdoors or both – please tick (please read guidance note 3)</b>	Indoors	<input type="checkbox"/>
				Outdoors	<input type="checkbox"/>
				Both	<input type="checkbox"/>
<b>Day</b>	<b>Start</b>	<b>Finish</b>	<b>Please give further details here (please read guidance note 4)</b>		
Mon					
Tue			<b>State any seasonal variations for the exhibition of films (please read guidance note 5)</b>		
Wed					
Thur					
Fri			<b>Non standard timings. Where you intend to use the premises for the exhibition of films at different times to those listed in the column on the left, please list (please read guidance note 6)</b>		
Sat					
Sun					

# C

<b>Indoor sporting events</b> Standard days and timings (please read guidance note 7)			Please give further details (please read guidance note 4)
Day	Start	Finish	
Mon			State any seasonal variations for indoor sporting events (please read guidance note 5)
Tue			
Wed			
Thur			Non standard timings. Where you intend to use the premises for indoor sporting events at different times to those listed in the column on the left, please list. (please read guidance note 6)
Fri			
Sat			
Sun			

# D

<b>Boxing or wrestling entertainment</b> Standard days and timings (please read guidance note 7)			Will the boxing or wrestling entertainment take place indoors or outdoors or both – please tick (please read guidance note 3)	Indoors	<input type="checkbox"/>
Day	Start	Finish		Outdoors	<input type="checkbox"/>
Mon			Please give further details here (please read guidance note 4)	Both	<input type="checkbox"/>
Tue					
Wed			State any seasonal variations for the boxing or wrestling entertainment (please read guidance note 5)		
Thur					
Fri			Non standard timings. Where you intend to use the premises for boxing or wrestling entertainment at different times to those listed in the column on the left, please list. (please read guidance note 6)		
Sat					
Sun					

# E

<b>Live music</b> Standard days and timings (please read guidance note 7)			<b>Will the performance of live music take place indoors or outdoors or both – please tick (please read guidance note 3)</b>	Indoors	<input type="checkbox"/>
				Outdoors	<input type="checkbox"/>
				Both	<input type="checkbox"/>
<b>Day</b>	<b>Start</b>	<b>Finish</b>	<b>Please give further details here (please read guidance note 4)</b>		
Mon					
Tue			<b>State any seasonal variations for the performance of live music (please read guidance note 5)</b>		
Wed					
Thur			<b>Non standard timings. Where you intend to use the premises for the performance of live music at different times to those listed in the column on the left, please list. (Please read guidance note 6)</b>		
Fri					
Sat					
Sun					

# F

<b>Recorded music</b> Standard days and timings (please read guidance note 7)			<b>Will the playing of recorded music take place indoors or outdoors or both – please tick (please read guidance note 3)</b>	Indoors	<input type="checkbox"/>
				Outdoors	<input type="checkbox"/>
				Both	<input type="checkbox"/>
<b>Day</b>	<b>Start</b>	<b>Finish</b>	<b>Please give further details here (please read guidance note 4)</b>		
Mon					
Tue			<b>State any seasonal variations for the playing of recorded music (please read guidance note 5)</b>		
Wed					
Thur			<b>Non standard timings. Where you intend to use the premises for the playing of recorded music at different times to those listed in the column on the left, please list. (please read guidance note 6)</b>		
Fri					
Sat					
Sun					



# G

<b>Performance of dance</b> Standard days and timings (please read guidance note 7)			<b>Will the performance of dance take place indoors or outdoors or both – please tick (please read guidance note 3)</b>	<b>Indoors</b>	<input type="checkbox"/>
				<b>Outdoors</b>	<input type="checkbox"/>
				<b>Both</b>	<input type="checkbox"/>
<b>Day</b>	<b>Start</b>	<b>Finish</b>	<b>Please give further details here (please read guidance note 4)</b>		
Mon					
Tue			<b>State any seasonal variations for the performance of dance (please read guidance note 5)</b>		
Wed					
Thur			<b>Non standard timings. Where you intend to use the premises for the performance of dance at different times to those listed in the column on the left, please list. (please read guidance note 6)</b>		
Fri					
Sat					
Sun					

# H

<b>Anything of a similar description to that falling within (e), (f) or (g)</b> Standard days and timings (please read guidance note 7)			<b>Please give a description of the type of entertainment you will be providing</b>		
			<b>Will the entertainment take place indoors or outdoors or both – please tick (please read guidance note 3)</b>	<b>Indoors</b>	<input type="checkbox"/>
				<b>Outdoors</b>	<input type="checkbox"/>
				<b>Both</b>	<input type="checkbox"/>
<b>Day</b>	<b>Start</b>	<b>Finish</b>	<b>Please give further details here (please read guidance note 4)</b>		
Mon					
Tue			<b>State any seasonal variations for the entertainment of a similar description to that falling within (e), (f) or (g) (please read guidance note 5)</b>		
Wed					
Thur			<b>Non standard timings. Where you intend to use the premises for the entertainment of a similar description to that falling within (e), (f) or (g) at different times to those listed in the column on the left, please list. (please read guidance note 6)</b>		
Fri					
Sat					
Sun					



State the name and details of the individual whom you wish to specify on the licence as the designated premises supervisor (please see declaration about the entitlement to work in the checklist at the end of the form)

Name

N/A

No ALCOHOL

Address

Postcode

Personal licence number (if known)

Issuing licensing authority (if known)

**K**

Please highlight any adult entertainment or services, activities, other entertainment or matters ancillary to the use of the premises that may give rise to concern in respect of children (please read guidance note 9)

N/A



# M

Describe the steps you intend to take to promote the four licensing objectives:

a) General – all four licensing objectives (b, c, d, e) (please read guidance note 10)

WE HAVE FOUR CAMERAS 24hr RECORDING AND MONITORING CCTV  
LICENSEE HOLDER WILL BE ON SITE 12hrs PER DAY AND RESIDES  
LESS THAN 1 MILE AWAY FROM SITE.  
NON ALCOHOL LICENSE.

b) The prevention of crime and disorder

WE HAVE 3 STAFF MEMBERS AFTER 6pm CONSTANTLY MONITORING  
AND OPERATING IN THE CAR PARK. AS THERE IS NO SEATING  
AND WE ARE A TAKE AWAY AND GO SERVICE. WE MONITOR BEHAVIOUR  
AND THERE IS AMPLE LIGHTING AND CCTV AND NOTICE INFORMING  
CUSTOMERS OF THIS.

c) Public safety

CAR PARK ATTENDANTS ON OUR BUSY TIMINGS TO HELP MONITOR AND  
ASSIST IN PARKING. WE OPERATE A ONE WAY SYSTEM INTO THE  
CARPARK AND LEAVING FROM THE REAR CARPARK TO MAINTAIN A  
SWIFT FLOWING  
WE HAVE FIRST AID IF REQUIRED AND 3 ATTENDANTS AT PEAK TIMES.

d) The prevention of public nuisance

NOISE AND MUSIC NOW APPLICABLE TO OUR USE.  
WE HAVE A FULL TIME CARE TAKER CLEANS LITTER  
NO COOKING OR FRYING ON SITE NO AIR POLLUTION

a) The protection of children from harm

NOW APPLICABLE DRIVE THRU CAFE AND LIGHT SNACKS

SECURITY GUARD ISA REGULATED ATTENDANT, TO BE PRESENT EVERY  
FRIDAY SATURDAY SUNDAY IN HIGH VIS OPERATING PARKING CONTROL  
AT THE MAIN ENTRANCE

**Checklist**

Please tick to indicate agreement

- I have made or enclosed payment of the fee
- I have enclosed the plan of the premises
- I have sent copies of this application and the plan to responsible authorities and others where applicable
- I have enclosed the consent form completed by the individual I wish to be designated premises supervisor, if applicable
- I understand that I must now advertise my application
- I understand that if I do not comply with the above requirements my application will be rejected

Applicable to all individual applicants, including those in partnership which is not a limited liability partnership, but not companies or limited liability partnerships

- I have included documents demonstrating my entitlement to work in the United Kingdom or my share code issued by the Home Office online right to work checking service (please read note 15)

**IT IS AN OFFENCE, UNDER SECTION 158 OF THE LICENSING ACT 2003 TO MAKE A FALSE STATEMENT IN OR IN CONNECTION WITH THIS APPLICATION. THOSE WHO MAKE A FALSE STATEMENT MAY BE LIABLE ON SUMMARY CONVICTION TO A FINE OF ANY AMOUNT.**

**IT IS AN OFFENCE UNDER SECTION 24B OF THE IMMIGRATION ACT 1971 FOR A PERSON TO WORK WHEN THEY KNOW, OR HAVE REASONABLE CAUSE TO BELIEVE, THAT THEY ARE DISQUALIFIED FROM DOING SO BY REASON OF THEIR IMMIGRATION STATUS. THOSE WHO EMPLOY AN ADULT WITHOUT LEAVE OR WHO IS SUBJECT TO CONDITIONS AS TO EMPLOYMENT WILL BE LIABLE TO A CIVIL PENALTY UNDER SECTION 15 OF THE IMMIGRATION ASYLUM AND NATIONALITY ACT 2006 AND PURUANT TO SECTION 21 OF THE SAME ACT, WILL BE COMMITTING AN OFFENCE WHERE THEY DO SO IN THE KNOWLEDGE, OR WITH REASONABLE CAUSE TO BELIEVE, THAT THE EMPLOYEE IS DISQUALIFIED.**

**Part 4 – Signatures** (please read guidance note 11)

**Signature of applicant or applicant’s solicitor or other duly authorised agent.** (See guidance note 12). **If signing on behalf of the applicant please state in what capacity.**

Declaration	<p>Applicable to individual applicants only, including those in a partnership which is not a limited liability partnership</p> <ul style="list-style-type: none"> <li>• I understand I am not entitled to be issued with a licence if I do not have the entitlement to live and work in the UK (or if I am subject to a condition preventing me from doing work relating to the carrying on of a licensable activity) and that my licence will become invalid if I cease to be entitled to live and work in the UK (please read guidance note 15).</li> <li>• The DPS named in this application form is entitled to work in the UK (and is not subject to conditions preventing him or her from doing work relating to a licensable activity) and I have seen a copy of his or her proof of entitlement to work, or have conducted an online right to work checking service which confirmed their right to work (please see note 15).</li> </ul>
Signature	
Date	08-02-2021
Capacity	DIRECTOR

For joint applications signature of 2<sup>nd</sup> applicant or 2<sup>nd</sup> applicant's solicitor or other authorised agent. (please read guidance note 13). If signing on behalf of the applicant please state in what capacity.

Signature	
Date	
Capacity	

<b>Contact Name (where not previously given) and address for correspondence associated with this application</b> (please read guidance note 14)	
ISRAH NABI [REDACTED] ASHWELL ROAD	
Post town	BRADFORD
Post code	BD8 9DP
Telephone number (if any)	[REDACTED]
If you would prefer us to correspond with you by e-mail, your e-mail address (optional)	
[REDACTED]@hotmail.co.uk	