



# We're Planning Changes to Forster Square Station

**We want to make a dramatic improvement to the station and we want to know what you think.**

Bradford Council and the West Yorkshire Combined Authority (WYCA) together with Network Rail and Northern are planning a major redevelopment of Bradford Forster Square Station.

We want your views on the design and the facilities that the station needs to become a great gateway to Bradford City Centre.





**We're planning to replace the existing station as well as the lift and staircase tower.**

**We want to:**

- Create a much larger building with a modern airy design, a glass front and a 'green' roof
- Install two new lifts to provide access to Cheapside/Manor Row
- Incorporate the arches behind the station and the lifts into the building
- Put 'pods' into the arches to provide extra station facilities
- Provide a café, toilets and ticket facilities in a smaller building within the building
- Improve the layout and access arrangements on the Valley Road side
- Clear up the overgrown area behind the station and provide a green space or 'pocket park'
- Note that we won't be making any changes to the railway tracks or the layout of the platforms.

**Survey**

What do you think of the proposals for Forster Square. Please rate from 1 to 5, with 1 being strongly disapprove and 5 being strongly approve.

(Please tick ✓)

1
  2
  3
  4
  5
  6
  7
  8
  9
  10

Please rate how important to you each of the following facilities would be, with 1 being not at all and 5 being very useful. (Please tick ✓)

**Cash Machine**

1
  2
  3
  4
  5
  6
  7
  8
  9
  10

**Heated Waiting Rooms**

1
  2
  3
  4
  5
  6
  7
  8
  9
  10

**Heated Waiting Rooms**

1
  2
  3
  4
  5
  6
  7
  8
  9
  10

**Toilets**

1
  2
  3
  4
  5
  6
  7
  8
  9
  10

**Cafe**

1
  2
  3
  4
  5
  6
  7
  8
  9
  10

**Two lifts as opposed to one**

1
  2
  3
  4
  5
  6
  7
  8
  9
  10

**Retail / Newsagents / Similar**

1
  2
  3
  4
  5
  6
  7
  8
  9
  10

**Indoor Cycle Parking** (Simple "U" tube)

1
  2
  3
  4
  5
  6
  7
  8
  9
  10

**Indoor Secure Cycle Parking** (Locked enclosure)

1
  2
  3
  4
  5
  6
  7
  8
  9
  10

**Both the lift shafts and the roofs of the pods could be topped with either pointed or rounded arches. See image on opposite page.**

**Which would you prefer to see** (please select one with a tick below)

Pointed
  Rounded
  Not Bothered

**We're looking for similar ideas about how to use the overgrown area behind platform 3 and in front of the arches. Do you have any ideas? We'd be particularly interested if you know of any organisation that would like to be involved in developing this space.**

Please give details below or leave blank.

**There is an opportunity to leave general comments in the space on the back of this leaflet.**

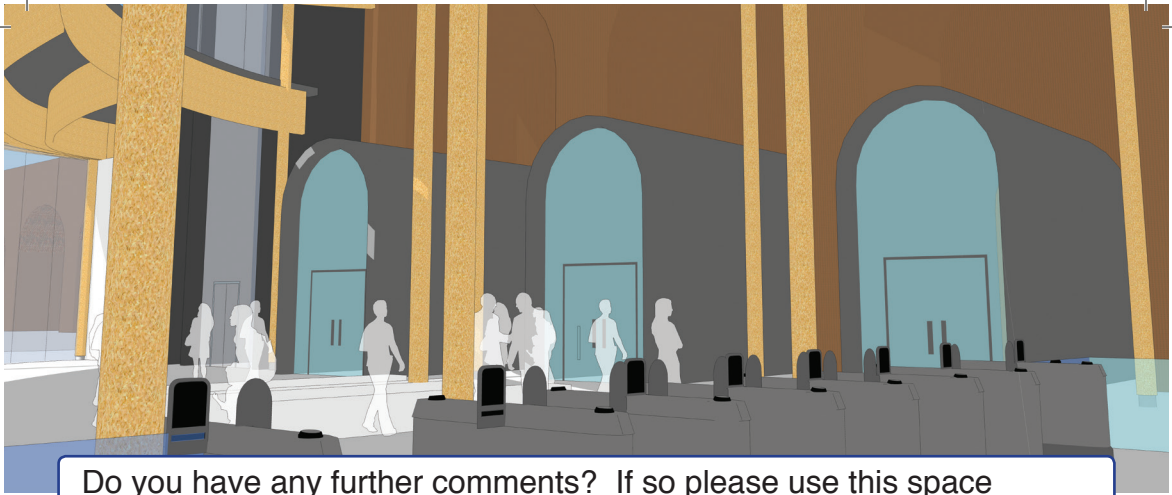

Do you have any further comments? If so please use this space



To complete this survey online go to [www.XXXXXXXXXXXXXXXXXXXXXXXXXXXXXX](http://www.XXXXXXXXXXXXXXXXXXXXXXXXXXXXXX)

(Note deadline of 20th December) or put this survey leaflet in the box at Forster Square Station on the 12th or 13th of December.

If you have any further comments or would like to get in touch with the team about the scheme you can email us at:

[Forstersquare@bradford.gov.uk](mailto:Forstersquare@bradford.gov.uk)

