

Licensing Act 2003 - Premises Licence

Licence No: 072559

Date Issued: 25 October 2016

Part 1 - Premises Details

POSTAL ADDRESS OF PREMISES, OR IF NONE, ORDNANCE SURVEY MAP REFERENCE OR DESCRIPTION

Top Odd

42 Town Gate, Wyke, Bradford, BD12 9NT

WHERE THE LICENCE IS TIME LIMITED THE DATES

Not applicable

DATE FIRST GRANTED - ANNUAL FEE DATE

Licensing Act 2003.Fees Regulations 2005

6 September 2005

LICENSABLE ACTIVITIES AUTHORISED BY THE LICENCE

A Performance of Live Music
Any Playing of Recorded Music
The Supply of Alcohol

THE TIMES THE LICENCE AUTHORISES THE CARRYING OUT OF LICENSABLE ACTIVITIES

A Performance of Live Music
Indoors

Mon 10:00-00:00

Tue 10:00-00:00

Wed 10:00-00:00

Thu 10:00-00:00

Fri 10:00-01:00

Sat 10:00-01:00

Sun 10:00-00:00

Christmas Day 11.00-15.00

Christmas Day 19.00-23.00

Boxing Day -

A further additional hour to those stated above.

New Years Eve -

10.00 hours until the start of permitted hours the following day.

Non Standard Timings: -

A further additional hour into the morning following on, Friday, Saturday, Sunday and Monday of every statutory Bank Holiday weekend.

<p>Any Playing of Recorded Music Indoors</p>	<p>Mon 10:00-00:00 Tue 10:00-00:00 Wed 10:00-00:00 Thu 10:00-00:00 Fri 10:00-01:00 Sat 10:00-01:00 Sun 10:00-00:00 Christmas Day 11.00-15.00 Christmas Day 19.00-23.00 Boxing Day - A further additional hour to those stated above. New Years Eve - 10.00 hours until the start of permitted hours the following day. Non Standard Timings: - A further additional hour into the morning following on, Friday, Saturday, Sunday and Monday of every statutory Bank Holiday weekend.</p>
<p>The Supply of Alcohol</p>	<p>Mon 10:00-00:00 Tue 10:00-00:00 Wed 10:00-00:00 Thu 10:00-00:00 Fri 10:00-01:00 Sat 10:00-01:00 Sun 10:00-00:00 Christmas Day 11.00-15.00 Christmas Day 19.00-23.00 Boxing Day - A further additional hour to those stated above. New Years Eve - 10.00 hours until the start of permitted hours the following day. Non Standard Timings: - A further additional hour into the morning following on, Friday, Saturday, Sunday and Monday of every statutory Bank Holiday weekend.</p>

THE OPENING HOURS OF THE PREMISES

	<p>Mon 10:00-01:00 Tue 10:00-01:00 Wed 10:00-01:00 Thu 10:00-01:00 Fri 10:00-02:00 Sat 10:00-02:00 Sun 10:00-01:00 Christmas Day 11.00-16.00 Christmas Day 19.00-00.00 Boxing Day - A further additional hour to those stated above. New Years Eve - 10.00 hours until the start of permitted hours the following day. Non Standard Timings: - A further additional hour into the morning following on, Friday, Saturday, Sunday and Monday of every statutory Bank Holiday weekend.</p>
--	--

WHERE THE LICENCE AUTHORISES SUPPLY OF ALCOHOL WHETHER THIS IS ON AND/OR OFF SUPPLIES

The Supply of Alcohol On and Off Premises

NAME, (REGISTERED) ADDRESS, TELEPHONE NUMBER AND EMAIL (WHERE RELEVANT) OF HOLDER OF PREMISES LICENCE

Craft Union Pub Company Limited
3 Monkspath Hall Road, Shirley, Solihull, West Midlands, B90 4SJ

REGISTERED NUMBER OF HOLDER, FOR EXAMPLE COMPANY NUMBER, CHARITY NUMBER (WHERE APPLICABLE)

NAME, ADDRESS AND TELEPHONE NUMBER OF DESIGNATED PREMISES SUPERVISOR WHERE THE PREMISES LICENCE AUTHORISES THE SUPPLY OF ALCOHOL

Ms Joyce Linda Lees
1 Wilson Road, Wyke, Bradford, BD12 9HA

PERSONAL LICENCE NUMBER AND ISSUING AUTHORITY OF PERSONAL LICENCE HELD BY DESIGNATED PREMISES SUPERVISOR WHERE THE PREMISES LICENCE AUTHORISES FOR THE SUPPLY OF ALCOHOL

Licence Number: BD/PER3441

Issued By: Bradford

ANNEXES

Annex 1 – Mandatory Conditions

REQUIREMENT FOR A DESIGNATED PREMISES SUPERVISOR

No supply of alcohol may be made under the premises licence:

- (a) at a time when there is no designated premises supervisor in respect of the premises licence, or
- (b) at a time when the designated premises supervisor does not hold a personal licence or his personal licence is suspended.

AUTHORISATION OF PERSONAL LICENCE HOLDER

Every supply of alcohol under the premises licence must be made or authorised by a person who holds a personal licence.

IRRESPONSIBLE PROMOTIONS

The responsible person must ensure that staff on relevant premises do not carry out, arrange or participate in any irresponsible promotions in relation to the premises.

In this paragraph, an irresponsible promotion means any one or more of the following activities, or substantially similar activities, carried on for the purpose of encouraging the sale or supply of alcohol for consumption on the premises-

a) games or other activities which require or encourage, or are designed to require or encourage, individuals to,

- (i) drink a quantity of alcohol within a time limit (other than to drink alcohol sold or supplied on the premises before the cessation of the period in which the responsible person is authorised to sell or supply alcohol), or (ii) drink as much alcohol as possible (whether within a time limit or otherwise)

- b) provision of unlimited or unspecified quantities of alcohol free or for a fixed or discounted fee to the public or to a group defined by a particular characteristic in a manner which carries a significant risk of undermining a licensing objective,
- c) provision of free or discounted alcohol or any other thing as a prize to encourage or reward the purchase and consumption of alcohol over a period of 24 hours or less in a manner which carries a significant risk of undermining a licensing objective,
- d) selling or supplying alcohol in association with promotional posters or flyers on, or in the vicinity of, the premises which can reasonably be considered to condone, encourage or glamorise anti-social behaviour or to refer to the effects of drunkenness in any favourable manner,
- e) dispensing alcohol directly by one person into the mouth of another (other than where that other person is unable to drink without assistance by reason of disability).

DRINKING WATER

The responsible person must ensure that free potable water is provided on request to customers where it is reasonably available.

AGE VERIFICATION

The premises licence holder or club premises certificate holder must ensure that an age verification policy is adopted in respect of the premises in relation to the sale or supply of alcohol.

The designated premises supervisor in relation to the premises licence must ensure that the supply of alcohol at the premises is carried on in accordance with the age verification policy.

The policy must require individuals who appear to the responsible person to be under 18 years of age (or such older age as may be specified in the policy) to produce on request, before being served alcohol, identification bearing their photograph, date of birth and either –

- a) a holographic mark, or
- b) an ultraviolet feature.

DRINKS MEASURES

The responsible person must ensure that:

(a) where any of the following alcoholic drinks is sold or supplied for consumption on the premises (other than alcoholic drinks sold or supplied having been made up in advance ready for sale or supply in a securely closed container) it is available to customers in the following measures-

- (i) beer or cider: half pint
- (ii) gin, rum, vodka or whisky: 25ml or 35ml and
- (iii) still wine in a glass: 125 ml

(b) these measures are displayed in a menu, price list or other printed material which is available to customers on the premises, and

(c) where a customer does not in relation to a sale of alcohol specify the quantity of alcohol to be sold, the customer is made aware that these measures are available.

DUTY & TAX

A relevant person shall ensure that no alcohol is sold or supplied for consumption on or off the premises for a price which is less than the permitted price.

For the purposes of the condition set out in paragraph 1:

(a) 'duty' is to be construed in accordance with the Alcoholic Liquor Duties Act 1979,

(b) 'permitted price' is the price found by applying the formula 'P' equals 'D' plus ('D' times 'V'), where-

(i) P is the permitted price,

(ii) D is the amount of duty chargeable in relation to the alcohol as if the duty were charged on the date of the sale or supply of the alcohol, and

(iii) V is the rate of value added tax chargeable in relation to the alcohol as if the value added tax were charged on the date of the sale or supply of the alcohol,

(c) 'relevant person' means, in relation to premises in respect of which there is in force a premises licence-

(i) the holder of the premises licence,

(ii) the designated premises supervisor (if any) in respect of such a licence, or

(iii) the personal licence holder who makes or authorises a supply of alcohol under such a licence,

(d) 'relevant person' means, in relation to premises in respect of which there is in force a club premises certificate, any member or officer of the club present on the premises in a capacity which enables the member or officer to prevent the supply in question, and

(e) 'value added tax' means value added tax charged in accordance with the Value Added Tax Act 1994.

Where the permitted price given by Paragraph (b) of paragraph 2 would (apart from this paragraph) not be a whole number of pennies, the price given by that sub-paragraph shall be taken to be the price actually given by that sub-paragraph rounded up to the nearest penny.

Sub-paragraph (2) applies where the permitted price given by Paragraph (b) of paragraph 2 on a day ('the first day') would be different from the permitted price on the next day ('the second day') as a result of a change to the rate of duty or value added tax.

The permitted price which would apply on the first day applies to sales or supplies of alcohol which take place before the expiry of the period of 14 days beginning on the second day.

Annex 2 – Conditions Consistent with Operating Schedule

All Four Licensing Objectives

1. Staff shall be trained on the requirements of the Licensing Act 2003 with regard to the licensing objectives when they are recruited.

The Prevention Of Crime And Disorder

2. The Licensee shall at all times maintain a "zero tolerance" policy with regard to illegal drugs (including appropriate staff training in detection and prevention); and shall co-operate with the West Yorkshire Police's "Drugs Watch" initiative or any similar scheme.

Public Safety

None.

The Prevention Of Public Nuisance

3. A Notice shall be displayed in a prominent position near the exits reminding patrons to leave in a quiet and orderly manner.
4. The outdoor drinking areas are to be cleared of customers no later than 23.00 hours.
5. All windows and outward opening doors are to be kept closed after 23.30 hours.

The Protection Of Children From Harm

6. The Licensee shall enforce an effective recognised "proof of age policy" at all times and ensure appropriate staff training in its operation.

Annex 3 – Conditions attached after a hearing by the Licensing Authority

Not applicable

Licensing Act 2003 - Premises Licence Summary
Licence No: 072559

Date Issued: 25 October 2016

Premises Details

POSTAL ADDRESS OF PREMISES, OR IF NONE, ORDNANCE SURVEY MAP REFERENCE OR DESCRIPTION

Top Odd
42 Town Gate, Wyke, Bradford, BD12 9NT

WHERE THE LICENCE IS TIME LIMITED THE DATES

Not applicable

DATE FIRST GRANTED - ANNUAL FEE DATE

Licensing Act 2003 Fees Regulations 2005

6 September 2005

LICENSABLE ACTIVITIES AUTHORISED BY THE LICENCE

A Performance of Live Music
 Any Playing of Recorded Music
 The Supply of Alcohol

THE TIMES THE LICENCE AUTHORIZES THE CARRYING OUT OF LICENSABLE ACTIVITIES

A Performance of Live Music
 Indoors

Mon 10:00-00:00
 Tue 10:00-00:00
 Wed 10:00-00:00
 Thu 10:00-00:00
 Fri 10:00-01:00
 Sat 10:00-01:00
 Sun 10:00-00:00
 Christmas Day 11.00-15.00
 Christmas Day 19.00-23.00
 Boxing Day -
 A further additional hour to those stated above.
 New Years Eve -
 10.00 hours until the start of permitted hours the following day.
 Non Standard Timings: -
 A further additional hour into the morning following on, Friday, Saturday,
 Sunday and Monday of every statutory Bank Holiday weekend.

Any Playing of Recorded Music Indoors	<p>Mon 10:00-00:00 Tue 10:00-00:00 Wed 10:00-00:00 Thu 10:00-00:00 Fri 10:00-01:00 Sat 10:00-01:00 Sun 10:00-00:00 Christmas Day 11.00-15.00 Christmas Day 19.00-23.00 Boxing Day - A further additional hour to those stated above. New Years Eve - 10.00 hours until the start of permitted hours the following day. Non Standard Timings: - A further additional hour into the morning following on, Friday, Saturday, Sunday and Monday of every statutory Bank Holiday weekend.</p>
The Supply of Alcohol	<p>Mon 10:00-00:00 Tue 10:00-00:00 Wed 10:00-00:00 Thu 10:00-00:00 Fri 10:00-01:00 Sat 10:00-01:00 Sun 10:00-00:00 Christmas Day 11.00-15.00 Christmas Day 19.00-23.00 Boxing Day - A further additional hour to those stated above. New Years Eve - 10.00 hours until the start of permitted hours the following day. Non Standard Timings: - A further additional hour into the morning following on, Friday, Saturday, Sunday and Monday of every statutory Bank Holiday weekend.</p>

THE OPENING HOURS OF THE PREMISES

	<p>Mon 10:00-01:00 Tue 10:00-01:00 Wed 10:00-01:00 Thu 10:00-01:00 Fri 10:00-02:00 Sat 10:00-02:00 Sun 10:00-01:00 Christmas Day 11.00-16.00 Christmas Day 19.00-00.00 Boxing Day - A further additional hour to those stated above. New Years Eve - 10.00 hours until the start of permitted hours the following day. Non Standard Timings: - A further additional hour into the morning following on, Friday, Saturday, Sunday and Monday of every statutory Bank Holiday weekend.</p>
--	--

WHERE THE LICENCE AUTHORISES SUPPLY OF ALCOHOL WHETHER THIS IS ON AND/OR OFF SUPPLIES

The Supply of Alcohol On and Off Premises

NAME AND (REGISTERED) ADDRESS OF HOLDER OF PREMISES LICENCE

Craft Union Pub Company Limited
 3 Monkspath Hall Road, Shirley, Solihull, West Midlands, B90 4SJ

REGISTERED NUMBER OF HOLDER, FOR EXAMPLE COMPANY NUMBER, CHARITY NUMBER (WHERE APPLICABLE)

NAME OF DESIGNATED PREMISES SUPERVISOR WHERE THE PREMISES LICENCE AUTHORISES THE SUPPLY OF ALCOHOL

Ms Joyce Linda Lees

WHETHER ACCESS TO THE PREMISES BY CHILDREN IS RESTRICTED OR PROHIBITED

No restrictions.

External TV

Music to be played via management control sound leisure system

Licensable activities may take place in all public areas unless the premises licence specifies otherwise

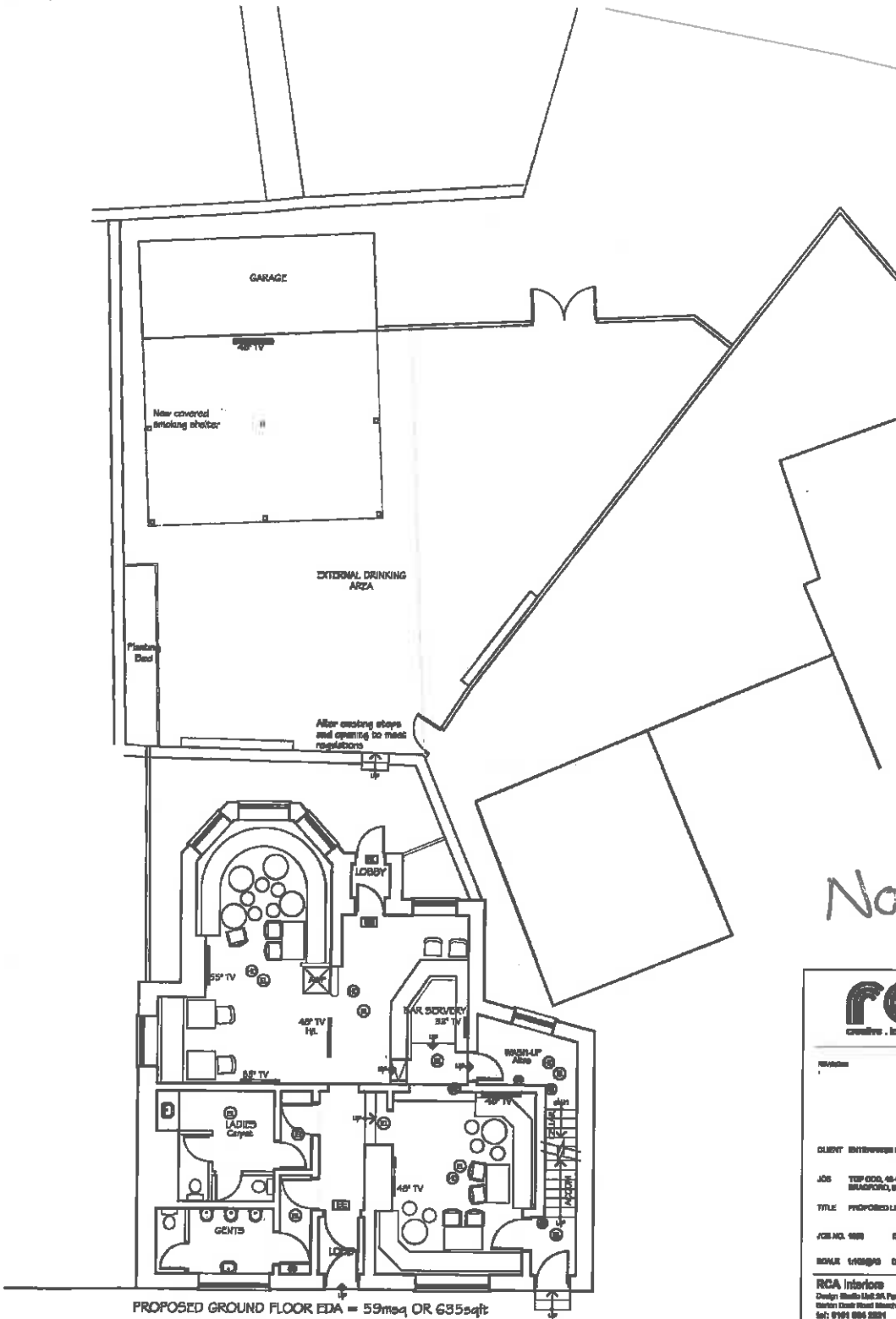

Nov 2016

RCA
creative . interior . design

CLIENT: BENTON & BOWLES
JOB: TSP 001, 45-48 YORK GATE, WYKE, BRADFORD, WF5 8WY
TITLE: PROPOSED LICENSING PLAN
JOB NO. 888 DRAWING NO. 1.1
SCALE: 1/100@A3 DATE: 18.03.16

RCA Interiors
Design Studio Ltd
Garton Road West Bradford WF5 8WY
Tel: 01937 886 889
Fax: 01937 891 892 www.rcainteriors.co.uk
RCA Interiors is a trading style of Robert Crawford Personnel Ltd