

Report of the Strategic Director of Regeneration and Culture to the meeting of the Area Planning Panel (KEIGHLEY AND SHIPLEY) to be held on 11 March 2015

Q

Summary Statement - Part Two

Miscellaneous Items

	<u>No. of Items</u>
Requests for Enforcement/Prosecution Action (page 65)	(2)
Decisions made by the Secretary of State – Dismissed (page 69)	(4)

Julian Jackson
Assistant Director (Planning, Transportation and Highways)

Report Contact: Mohammed Yousuf
Phone: 01274 434605

Email: mohammed.yousuf@bradford.gov.uk

Portfolio:
Housing, Planning & Transport

Overview & Scrutiny Committee Area:
Regeneration and Economy



Area Planning Panel (Keighley/Shipley)

14/00595/ENFAPP

11 March 2015

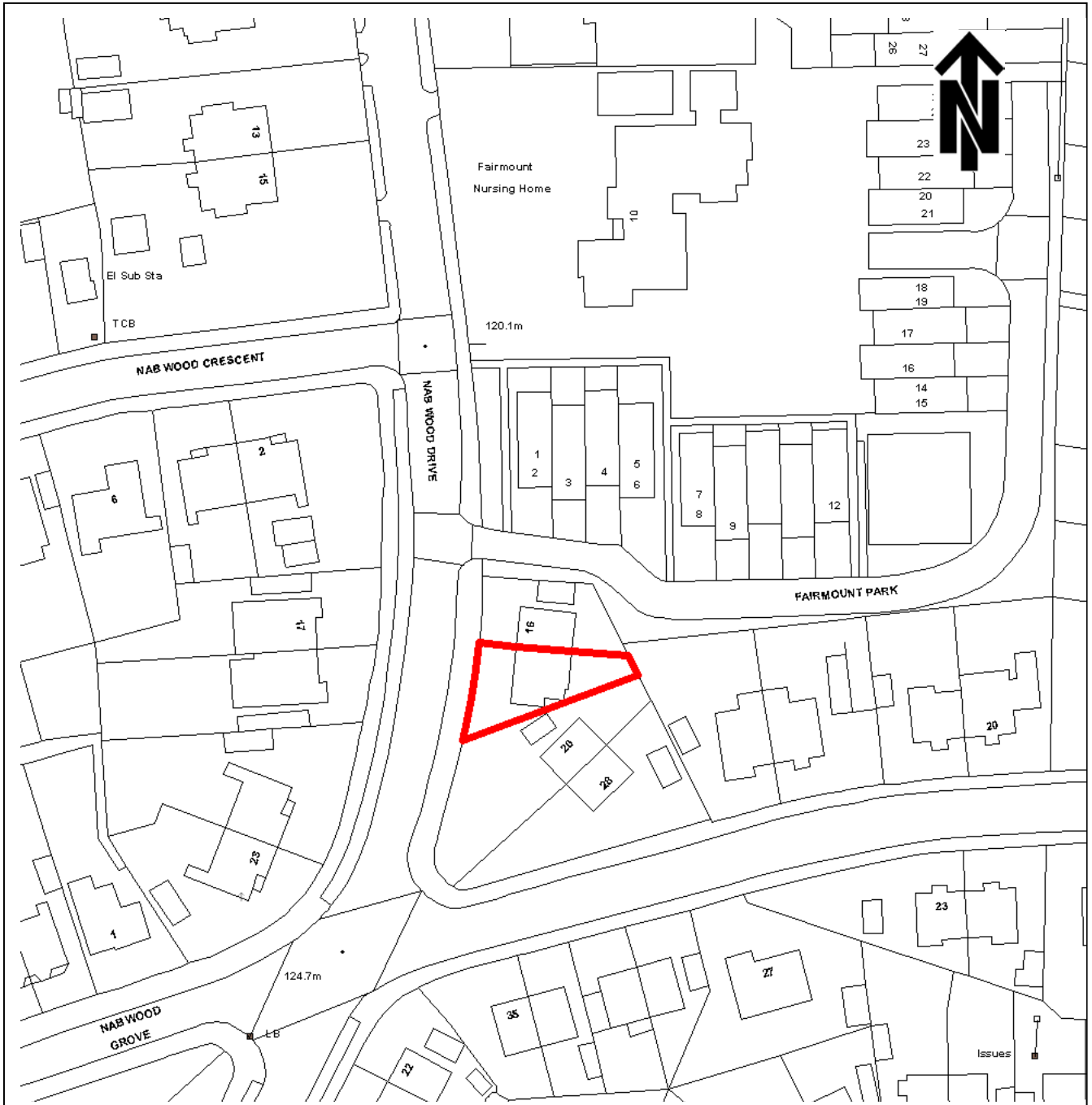

© Crown copyright 2000. All rights reserved (SLA 100019304)

ITEM NO. : 8

LOCATION:

**18 Nab Wood Drive
Shipley**

11 March 2015

Item Number: 8
Ward: SHIPLEY
Recommendation:
THAT THE REPORT BE NOTED

Enforcement Reference:
14/00595/ENFAPP

Site Location:
18 Nab Wood Drive, Shipley, BD18 4EJ.

Breach of Planning Control:
Two storey side and rear extension, hip to gable conversion and rear dormer window.

Circumstances:
It was brought to the attention of the Local Planning Authority that works were being carried out at the above property for which planning permission had not been sought. Despite discussions with the owner of the property, works have now stalled and the current state of the development is considered to be unacceptable. With no approved plan it is not possible to ensure satisfactory completion of the development.

The unauthorised works due to door design and relationship are detrimental to visual amenity and contrary to Policies UDP3, UR3 and D1 of the Replacement Unitary Development Plan, The National Planning Policy Framework and the Councils Householder Supplementary Planning Document.

The Planning Manager (Enforcement and Trees) authorised the issuing of an Enforcement Notice under delegated powers, on 16 February 2015.

Area Planning Panel (Keighley/Shipley)

11/00978/ENFUNA

11 March 2015

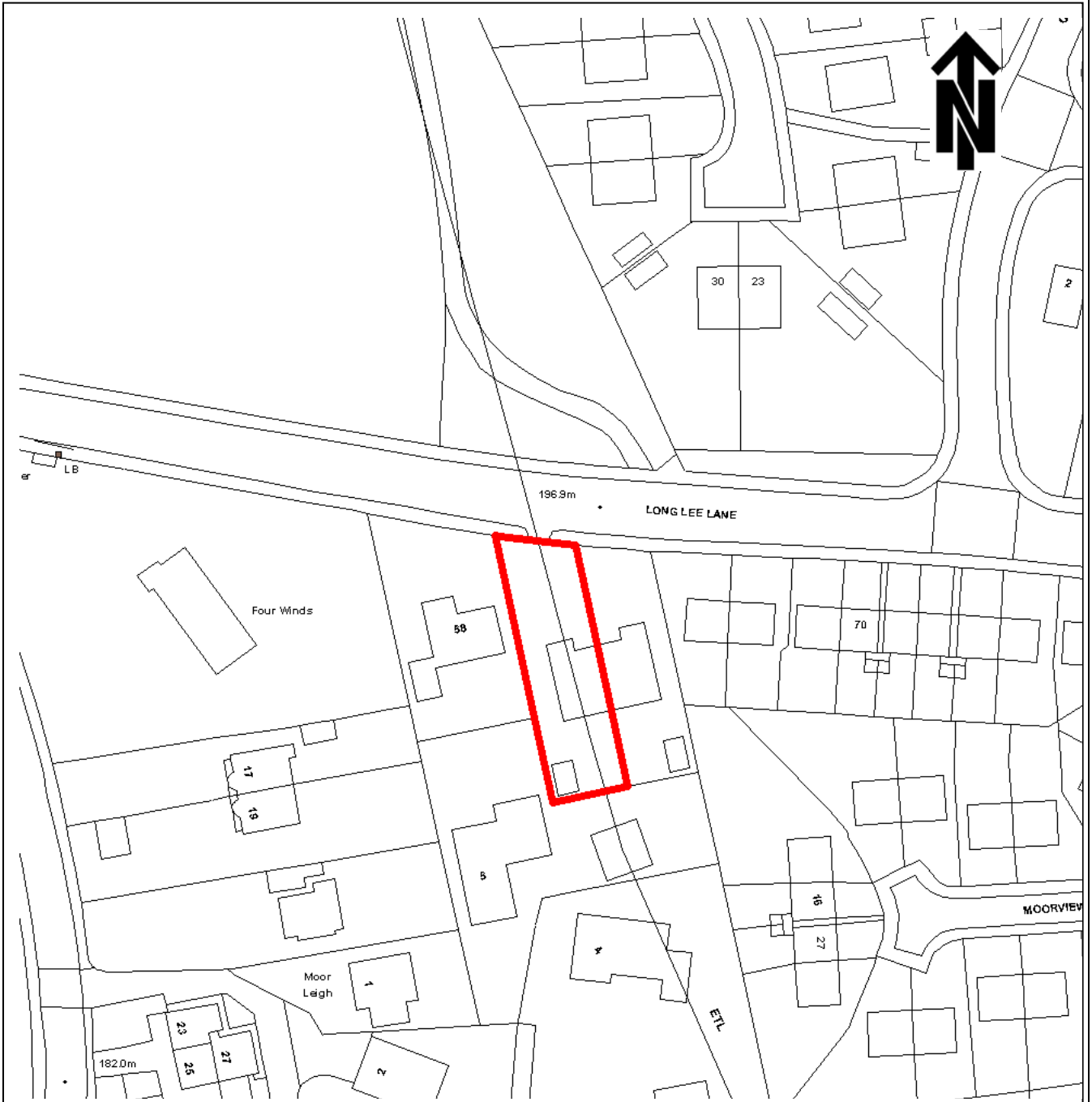

© Crown copyright 2000. All rights reserved (SLA 100019304)

<p>ITEM NO. : 9</p>	<p>LOCATION: 60 Long Lee Lane Long Lee Keighley</p>
----------------------------	--------------------------------------------------------------------

11 March 2015

Item Number: 9
Ward: KEIGHLEY EAST
Recommendation:
THAT THE REPORT BE NOTED

Enforcement Reference:
11/00978/ENFUNA

Site Location:
60 Long Lee Lane, Keighley

Breach of Planning Control:
Construction of a raised platform to the rear of a residential property.

Circumstances:
The case concerns the construction of a raised platform to the rear of a residential property resulting in overlooking of adjoining residential property. Planning permission was granted in 2013 subject to conditions to address the issues.

The platform is nearing completion but is in breach of condition 3 of 13/02085/HOU which required a close boarded screen to be constructed.

The Planning Manager (Enforcement and Trees) authorised an enforcement notice on 29 January 2015.

DECISIONS MADE BY THE SECRETARY OF STATE

Appeals Allowed

There are no Appeal Allowed Decisions to report this month

Appeal Dismissed

<u>ITEM No.</u>	<u>WARD</u>	<u>LOCATION</u>
10	Bingley (ward 02)	18 Grange Road Eldwick Bingley BD16 3DH Construction of side extension with front dormer and loft conversion - Case No: 14/03381/HOU Appeal Ref: 15/00003/APPHOU
11	Ilkley (ward 14)	24 Parish Ghyll Road Ilkley LS29 9NE Construction of single storey green roof dwelling - Case No: 13/02705/FUL Appeal Ref: 14/00053/APPFL2
12	Worth Valley (ward 29)	Cobling Barn Sawood Lane Oxenhope Keighley BD22 9SP Demolition of existing single storey extension and construction of two storey extension and single storey side extension - Case No: 14/03502/HOU Appeal Ref: 15/00002/APPHOU
13	Bingley (ward 02)	Land East Of 123 Gilstead Lane Gilstead Bingley Proposed three, two storey detached dwellings - Case No: 14/03725/FUL Appeal Ref: 14/00130/APPFL2

Appeals Upheld

There are no Appeal Upheld Decisions to report this month

Appeals Upheld (Enforcements Only)

There are no Appeal Upheld Decisions to report this month

Appeals Withdrawn

There are no Appeal Withdrawn Decisions to report this month

Appeal Allowed in Part/Part Dismissed

There are no Appeals Allowed in Part/Part Dismissed to report this month