

© Crown copyright 2017.
 All rights reserved.
 Licence number 100019304.

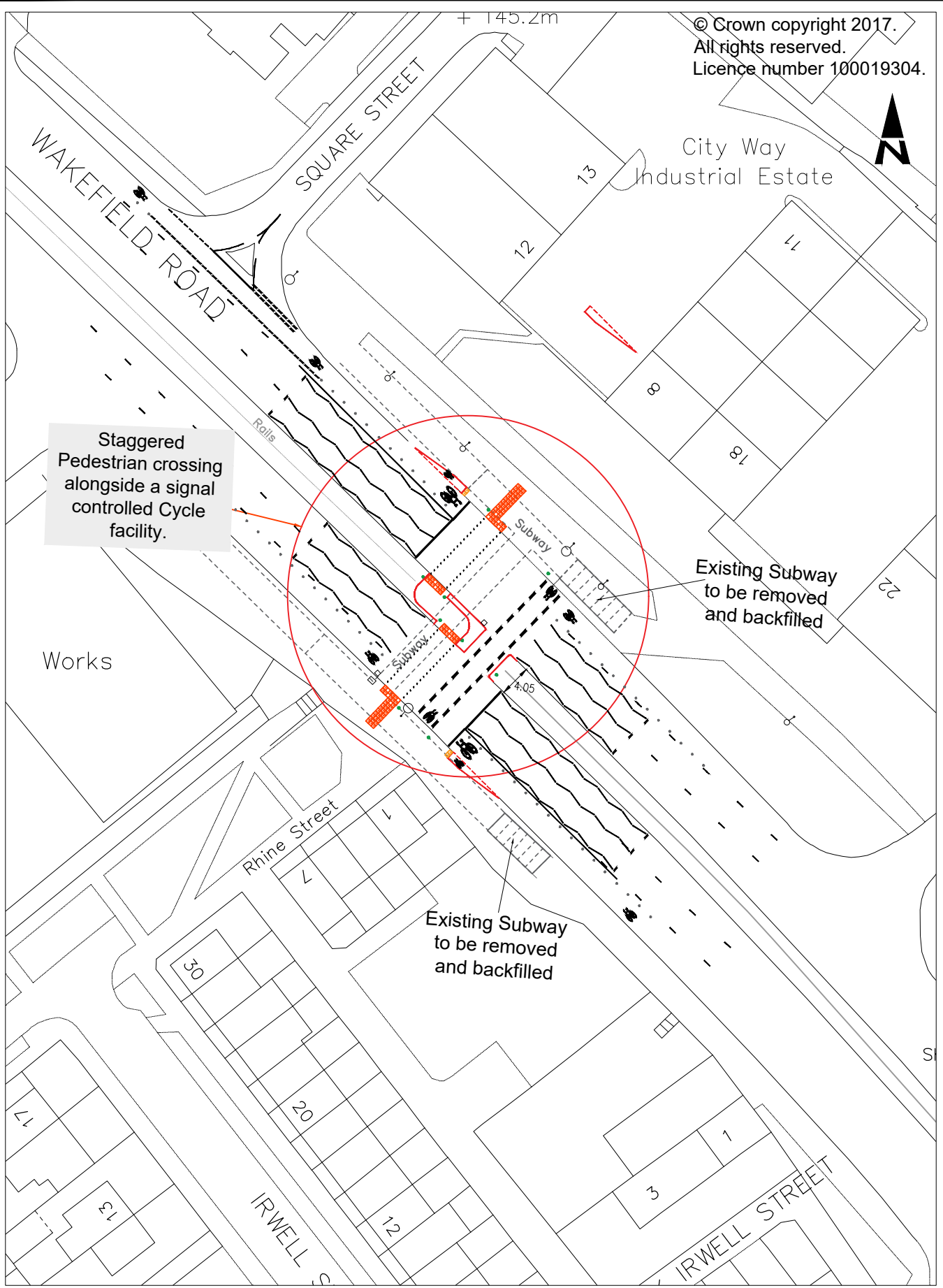

City Way
 Industrial Estate



Staggered
 Pedestrian crossing
 alongside a signal
 controlled Cycle
 facility.

Existing Subway
 to be removed
 and backfilled

Existing Subway
 to be removed
 and backfilled

Works

City of BRADFORD
 METROPOLITAN DISTRICT COUNCIL
 Department of Place
 Strategic Director: David Shepherd
 Design Office:
 Planning, Transportation & Highways Service
 Traffic & Highways Unit
 4th Floor
 Britannia House
 Hall Ings
 Bradford
 BD1 1HX

| | | | | | | | |
|----------------------|---|----------|----------|---------|----|----------|----|
| Design | AM | Drawn | AM | Checked | YM | Released | AM |
| Scale(s) @ A4 | NTS | | Approved | | AS | | |
| Date | April 23 | | | | | | |
| Engineer to Contract | Richard Gelder B.Eng(Hons), I.Eng, MICE | | | | | | |
| Revision | AM | 11.04.23 | Initials | Date | | | |
| Client | | | | | | | |

Project
 WAKEFIELD ROAD NEAR RHINE STREET, BRADFORD
 PROPOSED PUFFIN ALONGSIDE CYCLE CROSSING SIGNAL FACILITY
 Drawing Title
CONSULTATION PLAN
 Drawing No.
 HS/TRSS/105524/CON-1A